

**Advance Warning Signs**

**2 X** **AMS**

ROAD NAME CLOSED  
to to

**3 X** **SPECIAL SIGN**

LADDER HILL CLOSED THROUGH TRAFFIC FOLLOW DIVERSION

**KEY**

Traffic Cones

Traffic Sign Direction

Works Area

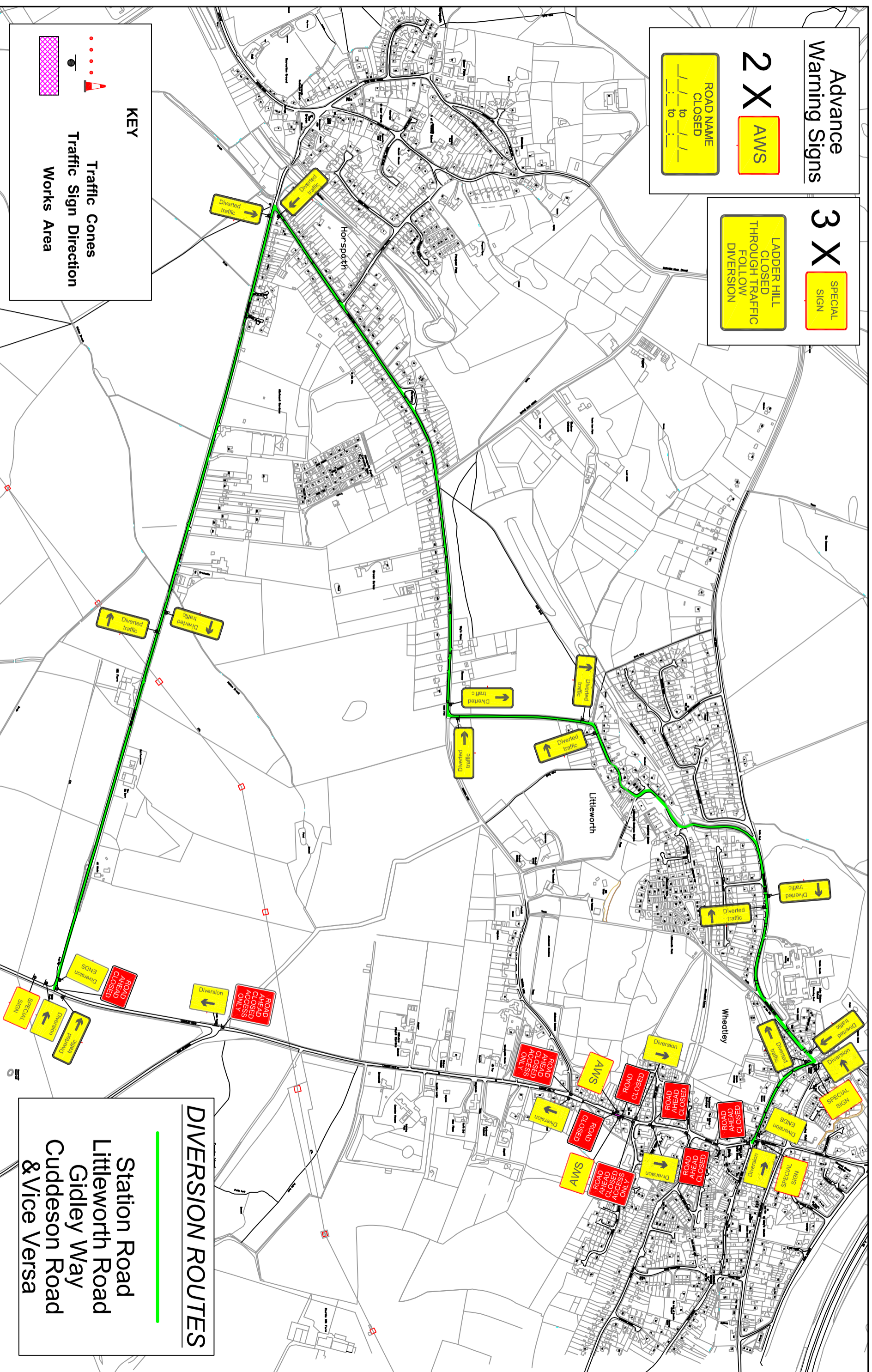

**DIVERSION ROUTES**

Station Road  
Litteworth Road  
Gidley Way  
Cuddeson Road  
& Vice Versa

**CAPPAGH**

LADDER HILL OX33 1SX  
ROAD CLOSURE & DIVERSION  
FOR SEWER WORKS  
TEL: 0800 6444 654

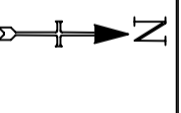

1) TEMPORARY TRAFFIC MANAGEMENT TO BE SET OUT IN ACCORDANCE WITH CHAPTER 8 AND SAFE WORKING PRACTICES.  
2) DUE TO OBSTRUCTIONS, LOCATIONS OF ADVANCE WARNING SIGNS MAY VARY ON SITE.  
3) THIS PLAN IS FOR THE SPECIFIED CLIENT. IT IS NOT TO BE COPIED, ALTERED, REPRODUCED OR REDISTRIBUTED WITHOUT AUTHORISATION FROM KEITON TRAFFIC MANAGEMENT.  
[www.ktmdrawings.com](http://www.ktmdrawings.com)

DATE DRAWN	06.06.16	Drawing No.	
DRAWN BY	KTM /J.D		
CHECKED BY	KTM/K.H.		
SCALE	N.T.S.		1061.66